

# NOZZLE TIPS

*Reduce Nozzle costs and increase flexibility*



## 2 Choices of materials

- **Chrome Vanadium Tungsten tool steel:**
  - Exceptional toughness and impact strength
  - Superior wear resistance
  - Resistance to high temperature fatigue
- **Beryllium Copper:**
  - Reduces tip freeze-offs
  - Eliminates stringing problems

### Replace only the tip for:

- Longer lengths for recessed sprue bushings
- Orifice size to reduce pressure drop at nozzle
- When radius is worn or damaged
- Internal design matching your type of plastic material

## Available in 3 Internal Designs

**GENERAL PURPOSE**  
(Straight Bore)

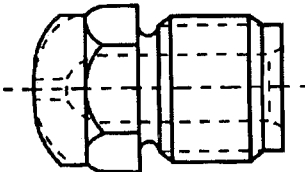

For all general purpose materials;  
i.e. styrene, polyethylene, polypropylene etc.

**NYLON**  
(Reverse Taper)

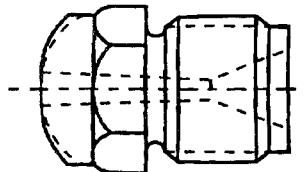

Reduces drool when  
processing nylon.

**FULL TAPER**

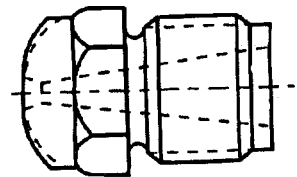

For use with ABS, PVC, acrylics  
and other engineering materials.



© 2009 MOLDERS CHOICE, Inc.

24 Hour Service - 7 Days a week  
**1-800-809-4623**  
 WebSite: [www.molderschoice.com](http://www.molderschoice.com) • Email: [molders@molderschoice.com](mailto:molders@molderschoice.com)