

# NOZZLE TIPS

*Reduce Nozzle costs and increase flexibility*



## 2 Choices of materials

- **Chrome Vanadium Tungsten tool steel:**
  - Exceptional toughness and impact strength
  - Superior wear resistance
  - Resistance to high temperature fatigue
- **Beryllium Copper:**
  - Reduces tip freeze-offs
  - Eliminates stringing problems

### Replace only the tip for:

- Longer lengths for recessed sprue bushings
- Orifice size to reduce pressure drop at nozzle
- When radius is worn or damaged
- Internal design matching your type of plastic material

## Available in 3 Internal Designs

**GENERAL PURPOSE**  
(Straight Bore)

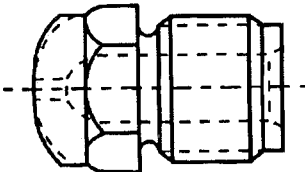

For all general purpose materials;  
i.e. styrene, polyethylene, polypropylene etc.

**NYLON**  
(Reverse Taper)

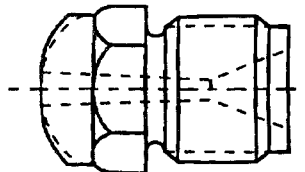

Reduces drool when  
processing nylon.

**FULL TAPER**

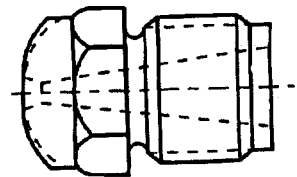

For use with ABS, PVC, acrylics  
and other engineering materials.



© 2009 MOLDERS CHOICE, Inc.

24 Hour Service - 7 Days a week  
**1-800-809-4623**  
 WebSite: [www.molderschoice.com](http://www.molderschoice.com) • Email: [molders@molderschoice.com](mailto:molders@molderschoice.com)

# TOOL STEEL or COPPER NICKEL NOZZLE TIPS

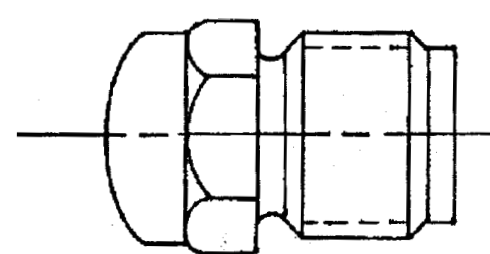
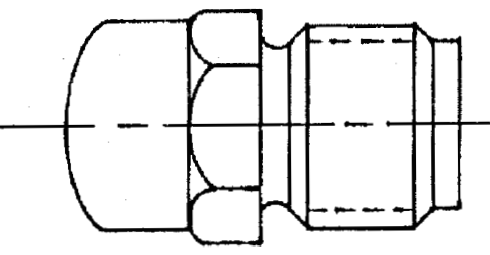
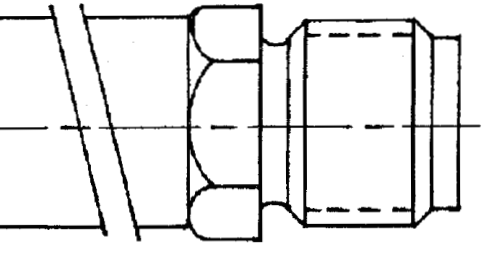
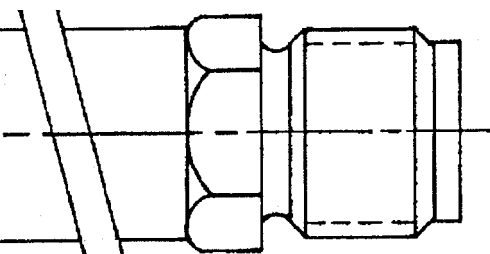
<p>1-1/2" OAL Adds 3/4" to body length</p>	 <p>Standard 7/8"-14 Thread, 1/2" R.O.</p>	<p><b>Tool Steel</b>                      General Purpose (GP) \$16.00                      Nylon (N) \$18.50                      Full Taper (FT) \$22.00  <b>Beryllium Copper</b>                      General Purpose (GPBC) \$25.00                      Nylon (NBC) \$26.00                      Full Taper (FTBC) \$26.00</p>
<p>2.75" OAL Adds 2" to body length Takes Standard or Keylock 1"x1" Heater Band</p>	 <p>Standard 7/8"-14 Thread, 1/2" R.O.</p>	<p><b>Tool Steel</b>                      General Purpose (GP) \$45.00                      Nylon (N) \$49.00                      Full Taper (FT) N/A  <b>Beryllium Copper</b>                      General Purpose (GPBC) INQUIRE                      Nylon (NBC) INQUIRE</p>
<p>3-3/4" OAL Adds 3-1/4" to body length Takes Standard or Keylock 1"x2" Heater Band</p>	 <p>Standard 7/8"-14 Thread, 1/2" R.O.</p>	<p><b>Tool Steel</b>                      General Purpose (GP) \$50.00                      Nylon (N) \$52.00                      Full Taper (FT) N/A  <b>Beryllium Copper</b>                      General Purpose (GPBC) INQUIRE                      Nylon (NBC) INQUIRE</p>
<p>5.00" OAL Adds 4.25" to body length Takes Standard or Keylock 1"x 4" Heater Band</p>	 <p>Standard 7/8"-14 Thread, 1/2" R.O.</p>	<p><b>Tool Steel</b>                      General Purpose (GP) \$85.00                      Nylon (N) \$88.00                      Full Taper (FT) N/A  <b>Beryllium Copper</b>                      General Purpose (GPBC) INQUIRE                      Nylon (NBC) INQUIRE</p>

## Ordering Information

For short 1-1/2" tips

	Radius	Orifice
GP	1/2" : 5	1/16" : .062    7/32" : .218
N	3/4" : 7	1/8" : .125    1/4" : .250
FT		5/32" : .156    5/16" : .312
GPBC		3/16" : .187    3/8" : .375
NBC		
FTBC		

For 2.75", 3.75" & 5" long tips

	Radius	Orifice
GP	1/2" : 5	1/16" : .062    7/32" : .218
N	3/4" : 7	1/8" : .125    1/4" : .250
GPBC		5/32" : .156    5/16" : .312
NBC		3/16" : .187    3/8" : .375
		2 : 2-3/4" OAL
		3 : 3-3/4" OAL
		5 : 5" OAL

© 2017 MOLDERS CHOICE, Inc.



24 Hour Service - 7 Days a week  
**1-800-809-4623**  
 WebSite: [www.molderschoice.com](http://www.molderschoice.com) • Email: [molders@molderschoice.com](mailto:molders@molderschoice.com)